

COMUNE DI SAN MAURO CILENTO  
COMUNE DI SERRAMEZZANA  
Provincia di Salerno

COMUNE DI CAPOFILA: SAN MAURO CILENTO

- PROGETTO ESECUTIVO -

MIGLIORAMENTO DELL'EFFICIENZA FUNZIONALE E MESSA  
IN SICUREZZA DELLA VIABILITA' INTERCOMUNALE TRA I  
COMUNI DI SAN MAURO CILENTO E SERRAMEZZANA

ELABORATI:

- PARTICOLARI COSTRUTTIVI

Tav.8

Data: Luglio 2019

**Studio Tecnico Perrotta**



Officina dell'Ingegneria

Via A. Aleardi, n. 62 - 84091 - Battipaglia (SA)

Tel. & Fax: 0828-305342

email: [info@studiotecnicoperrotta.it](mailto:info@studiotecnicoperrotta.it)

site web: [www.studiotecnicoperrotta.it](http://www.studiotecnicoperrotta.it)

IL TECNICO

*Ing. Massimo Perrotta*



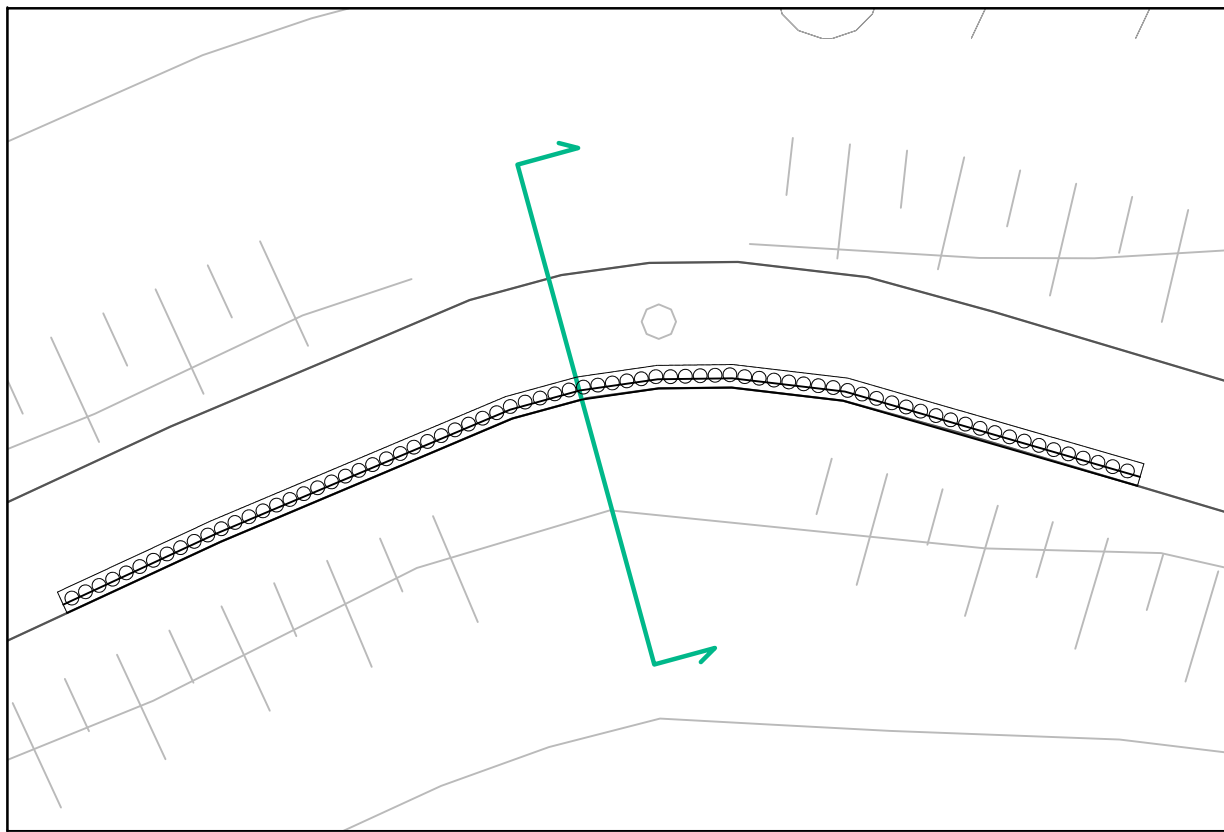

SEZIONE A-A - STATO DI FATTO

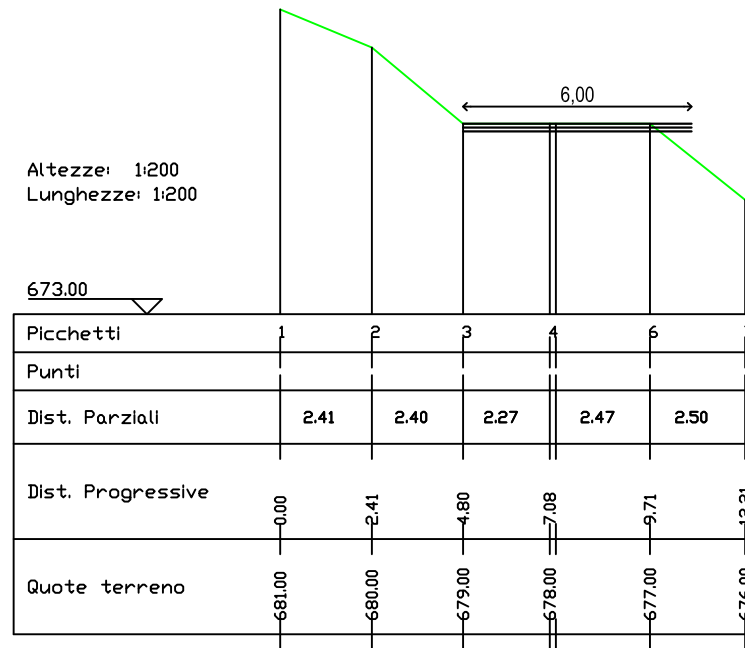

SEZIONE A-A - PROGETTO

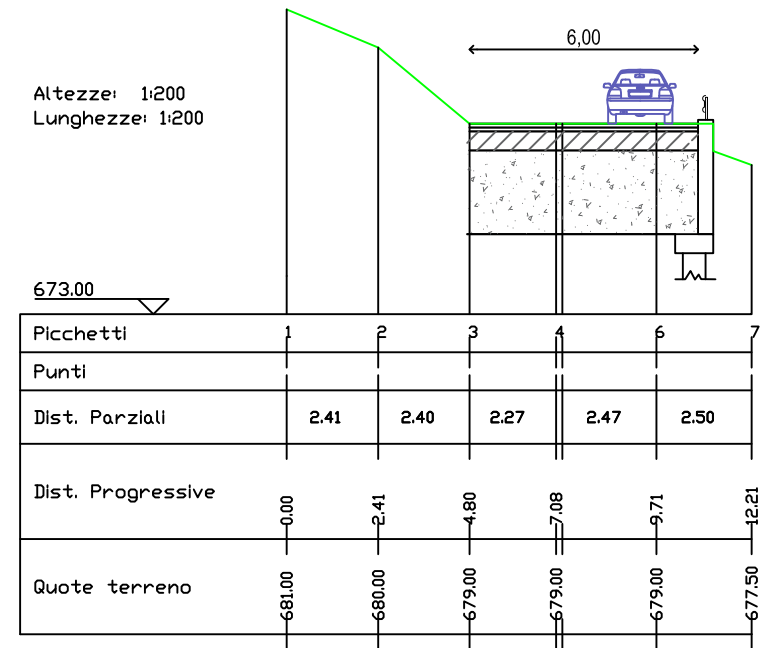

PARTICOLARE COSTRUTTIVO

sezione

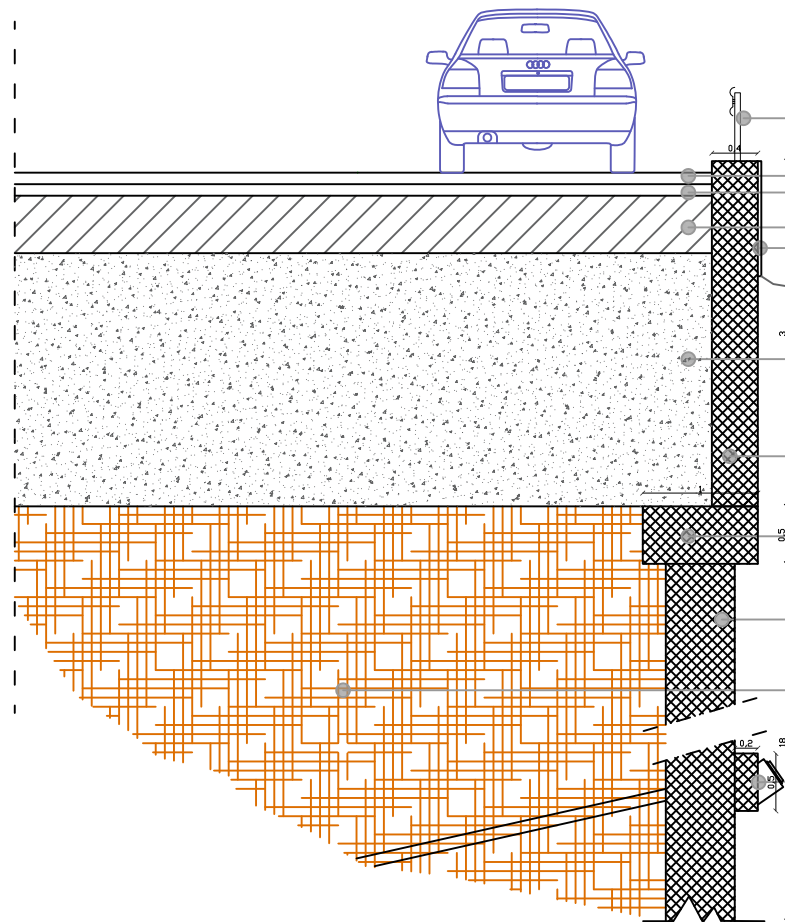

- GUARD-RAIL
- TAPPETINO  
BINDER
- STRATO DI BASE  
RIVESTIMENTO IN  
PIETRA
- STRATO DI FONDAZIONE  
IN MISTO GRANULARE
- MURO DI SOSTEGNO
- TRAVE IN CLS SU PALI
- PALO TRIVELLATO  
φ600 mm L=18 m
- TERRENO
- TIRANTE

prospetto

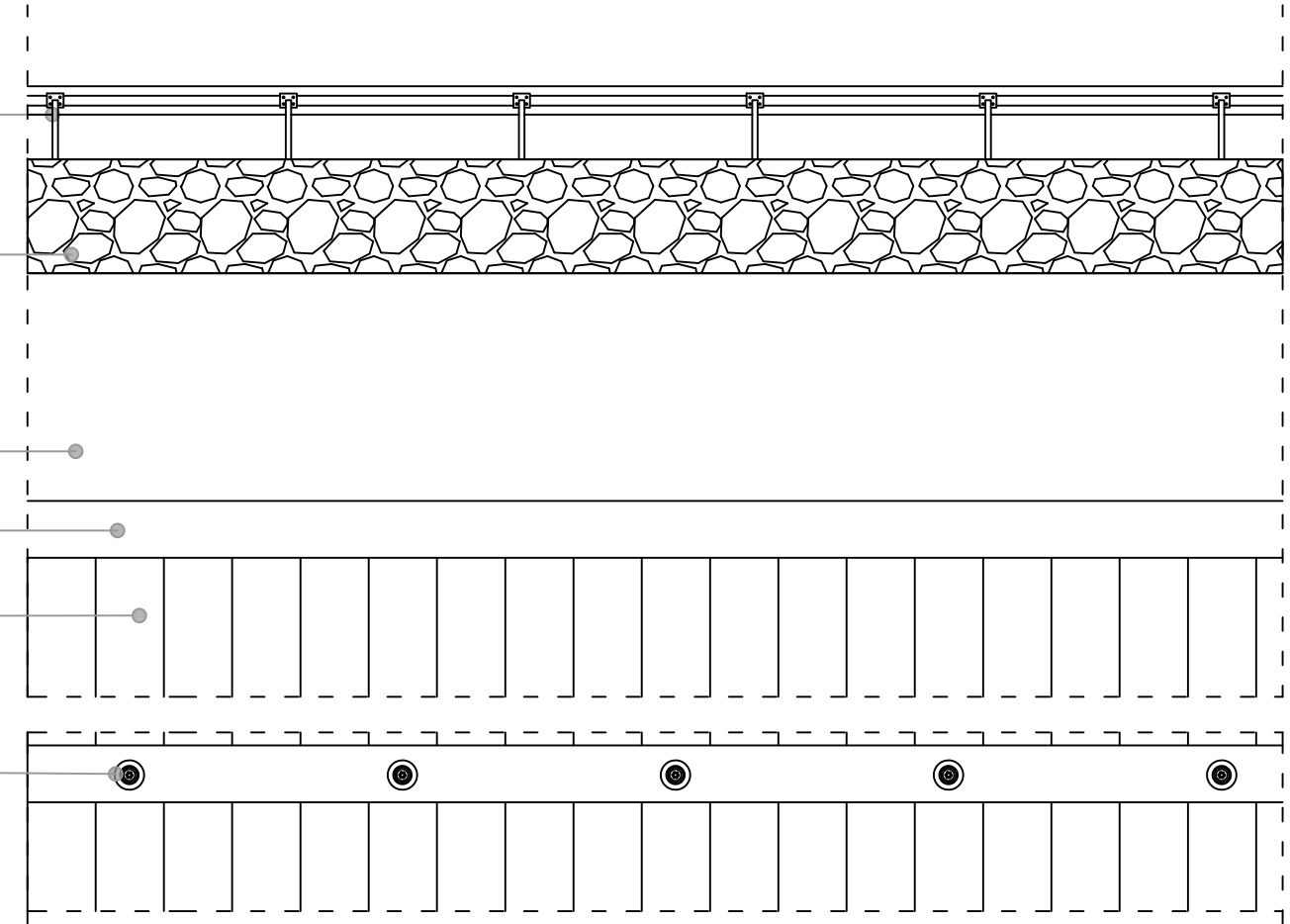

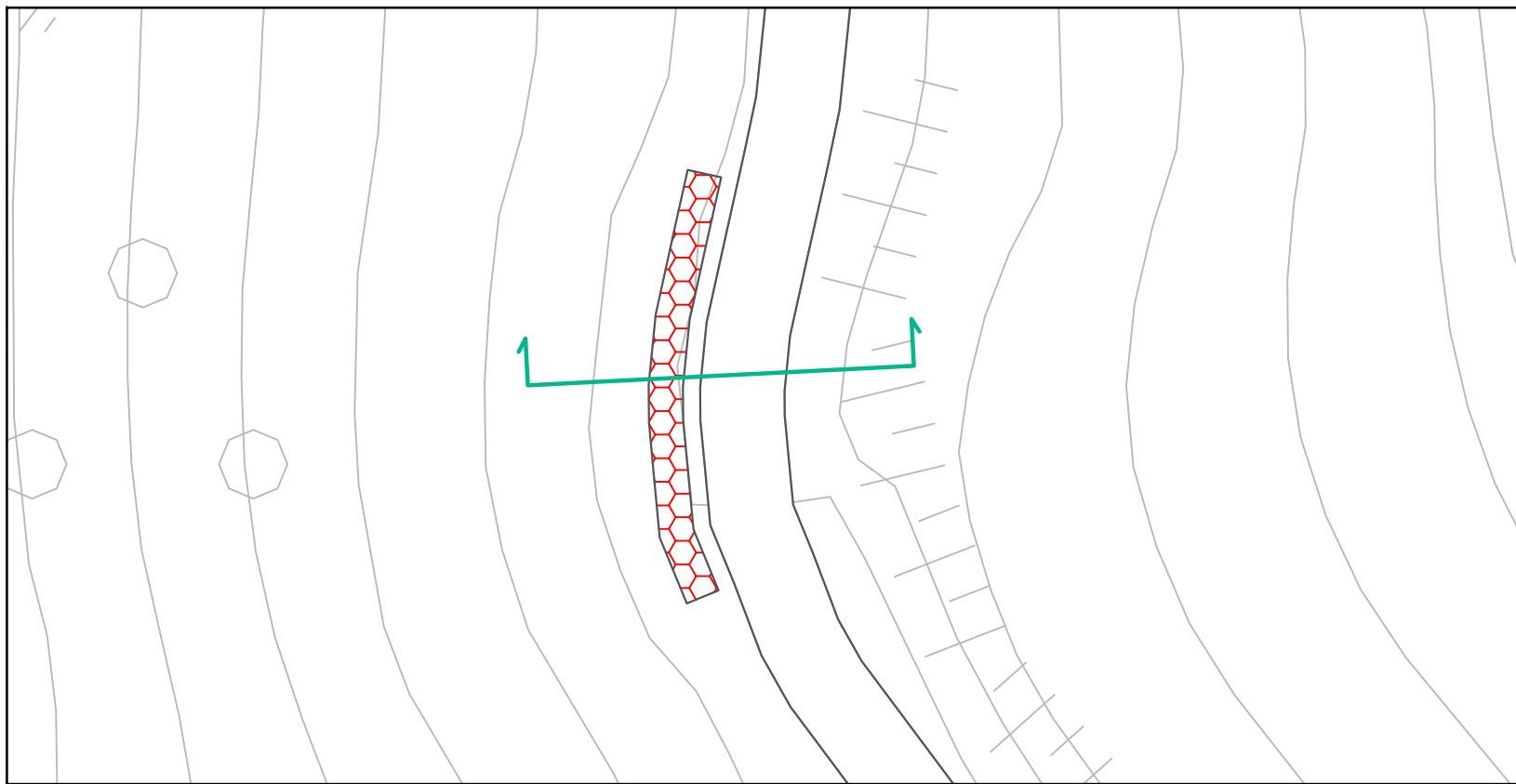

SEZIONE C-C - STATO DI FATTO

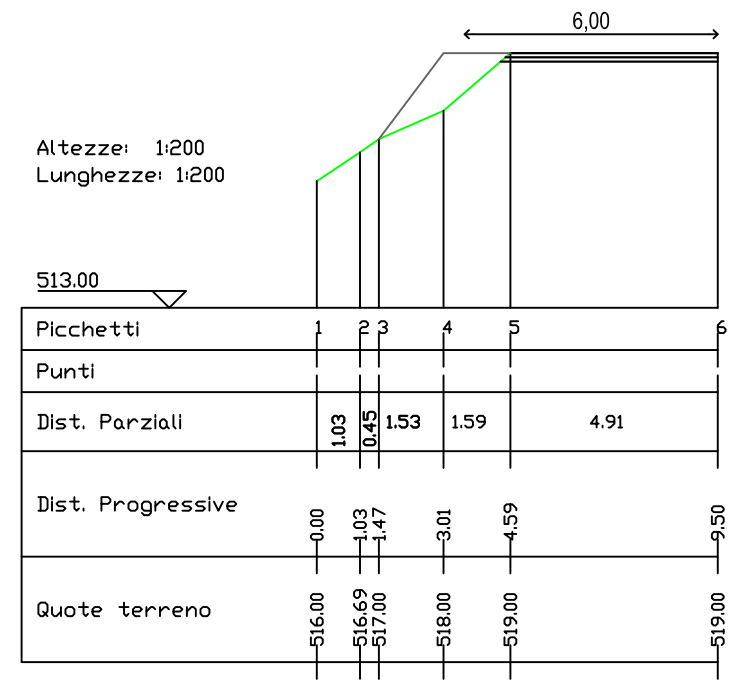

PARTICOLARE COSTRUTTIVO GABBIONATA

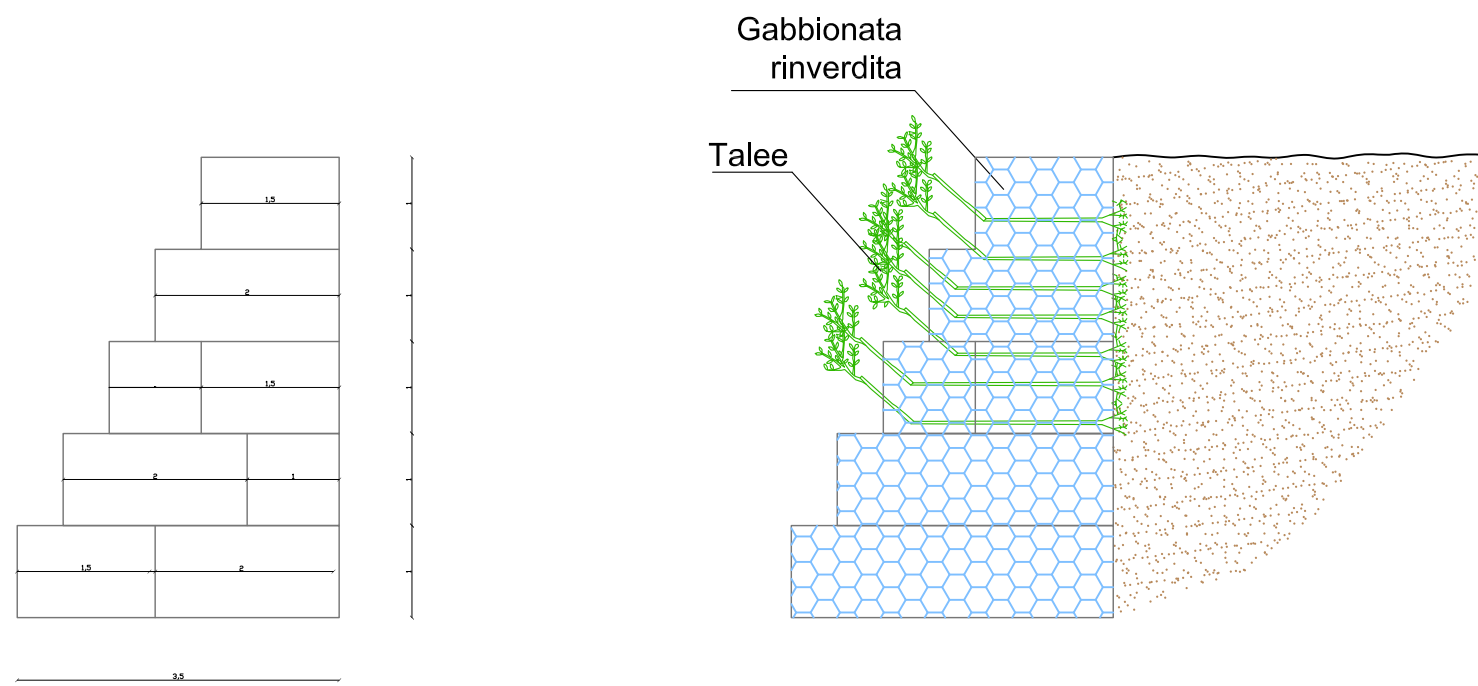

SEZIONE C-C - PROGETTO

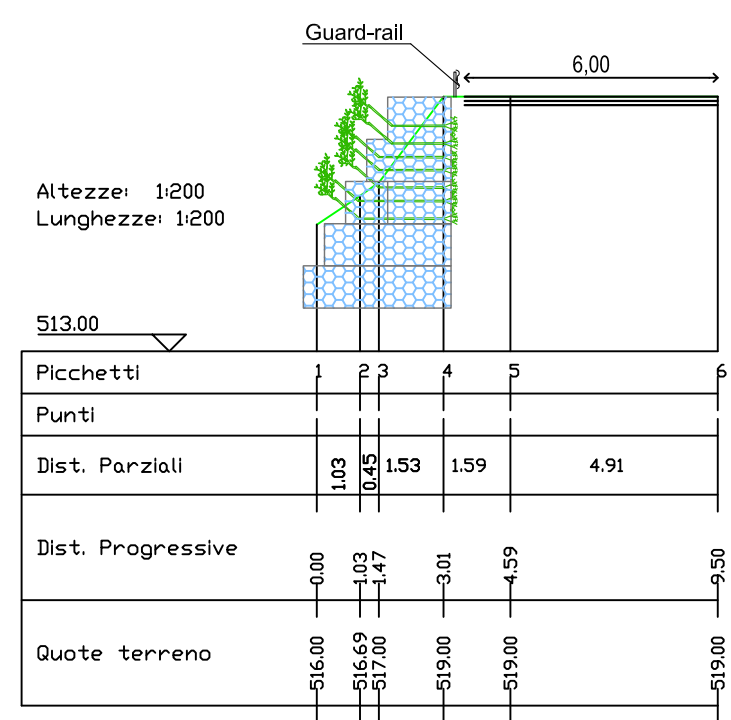

stato di fatto- sezione

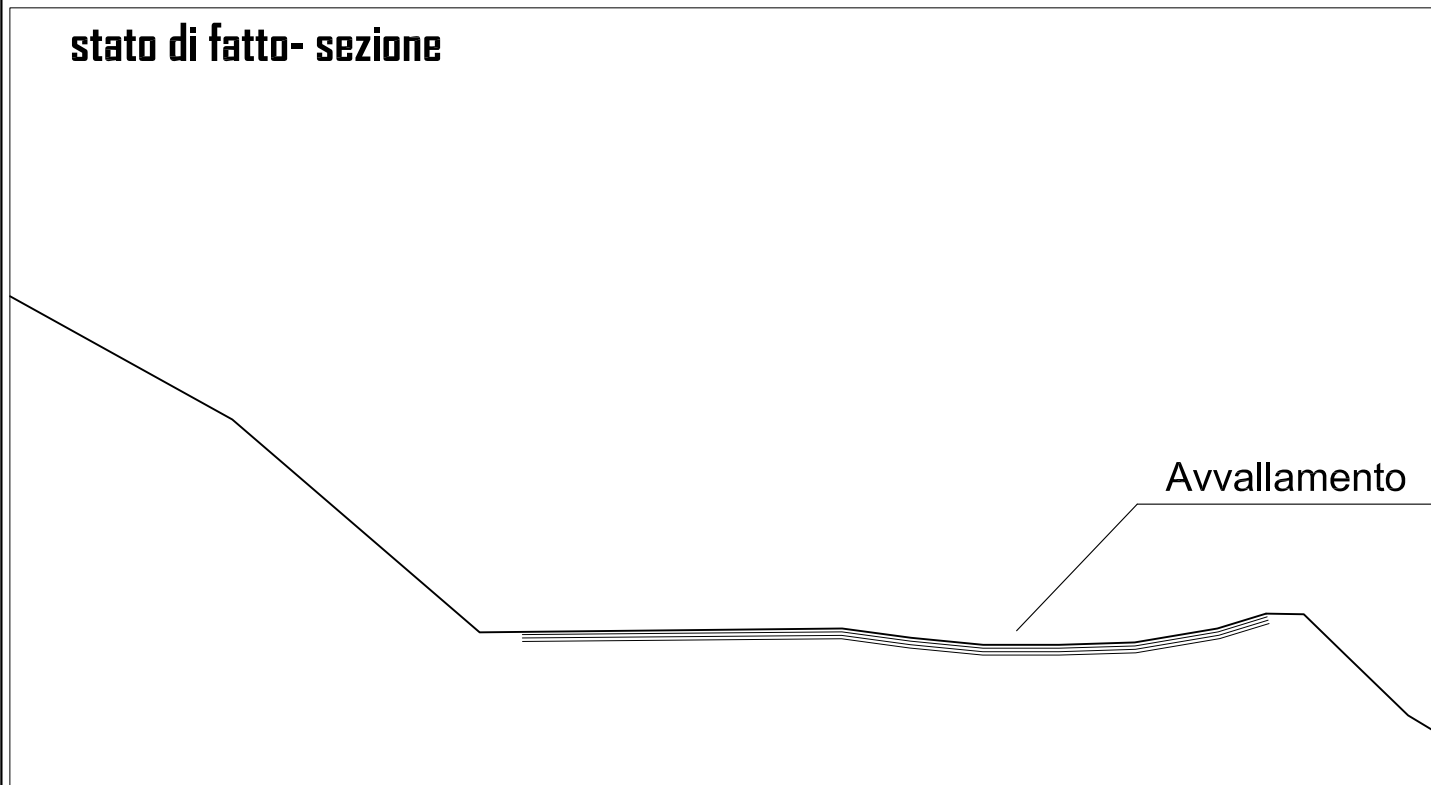

progetto- sezione

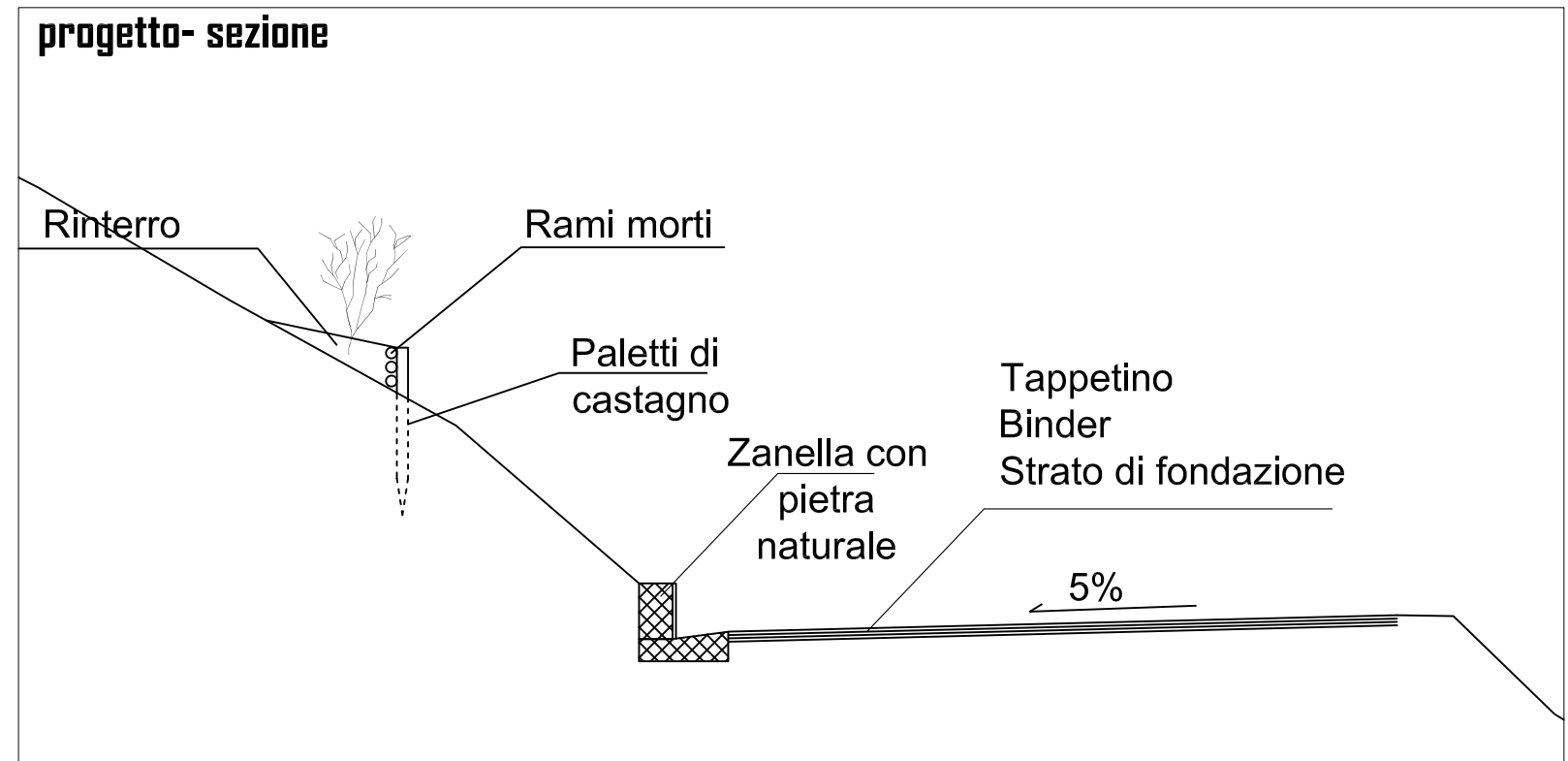

progetto-prospetto

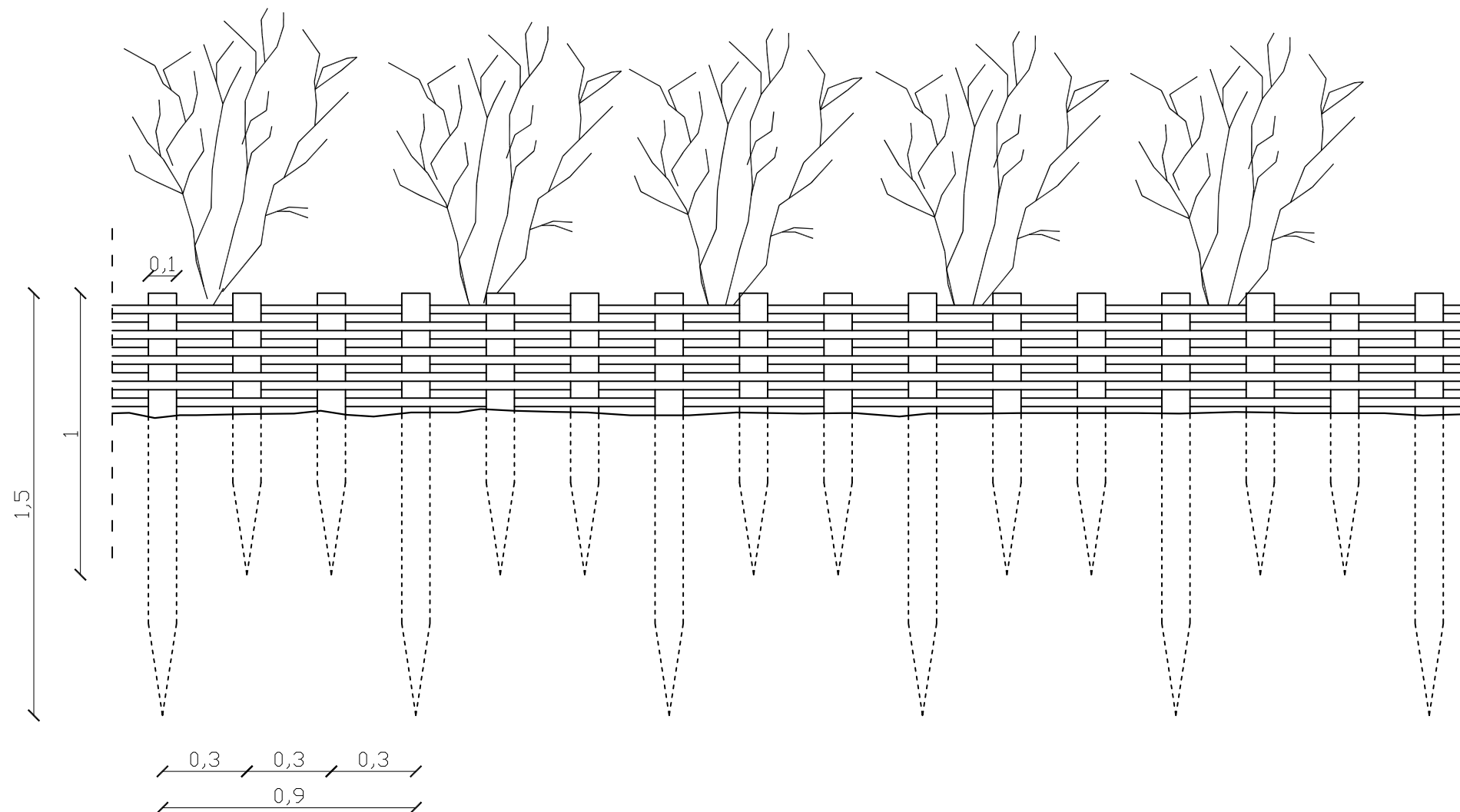

Zanella

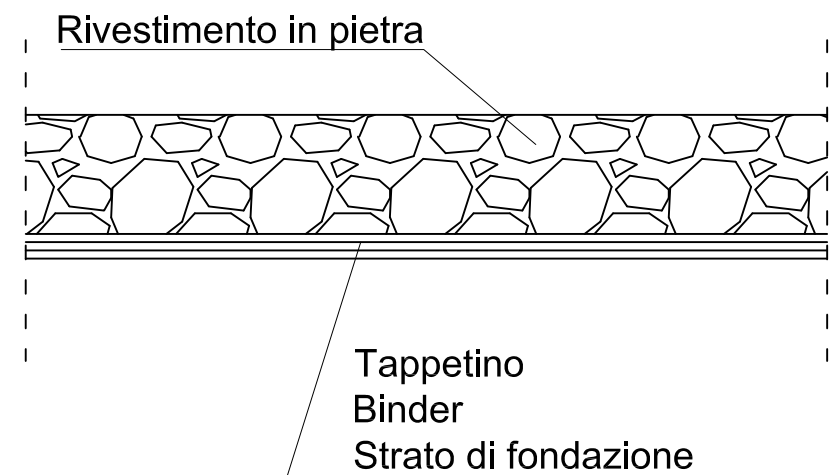
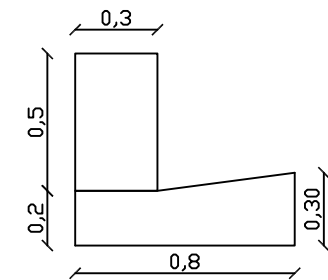

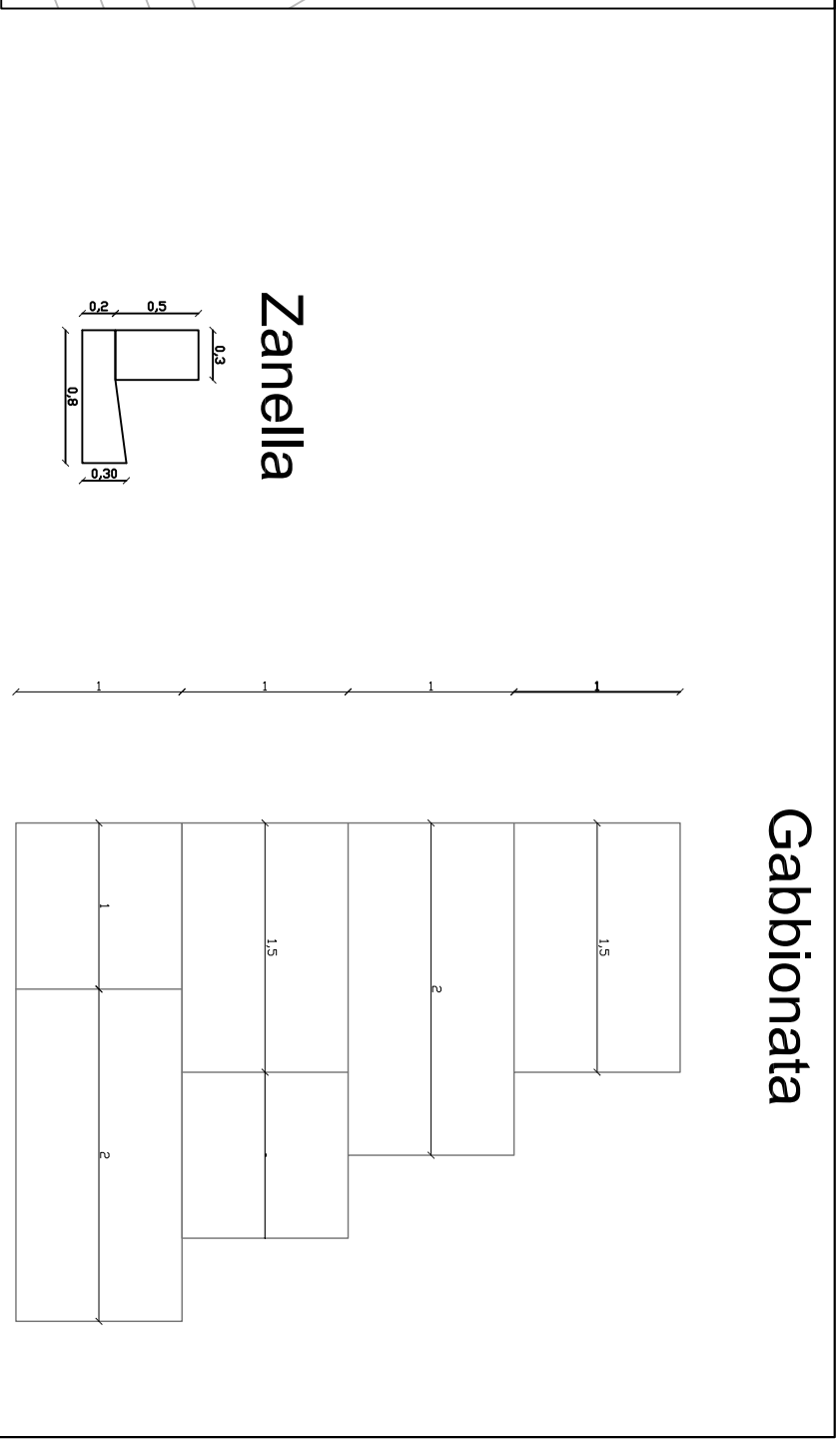
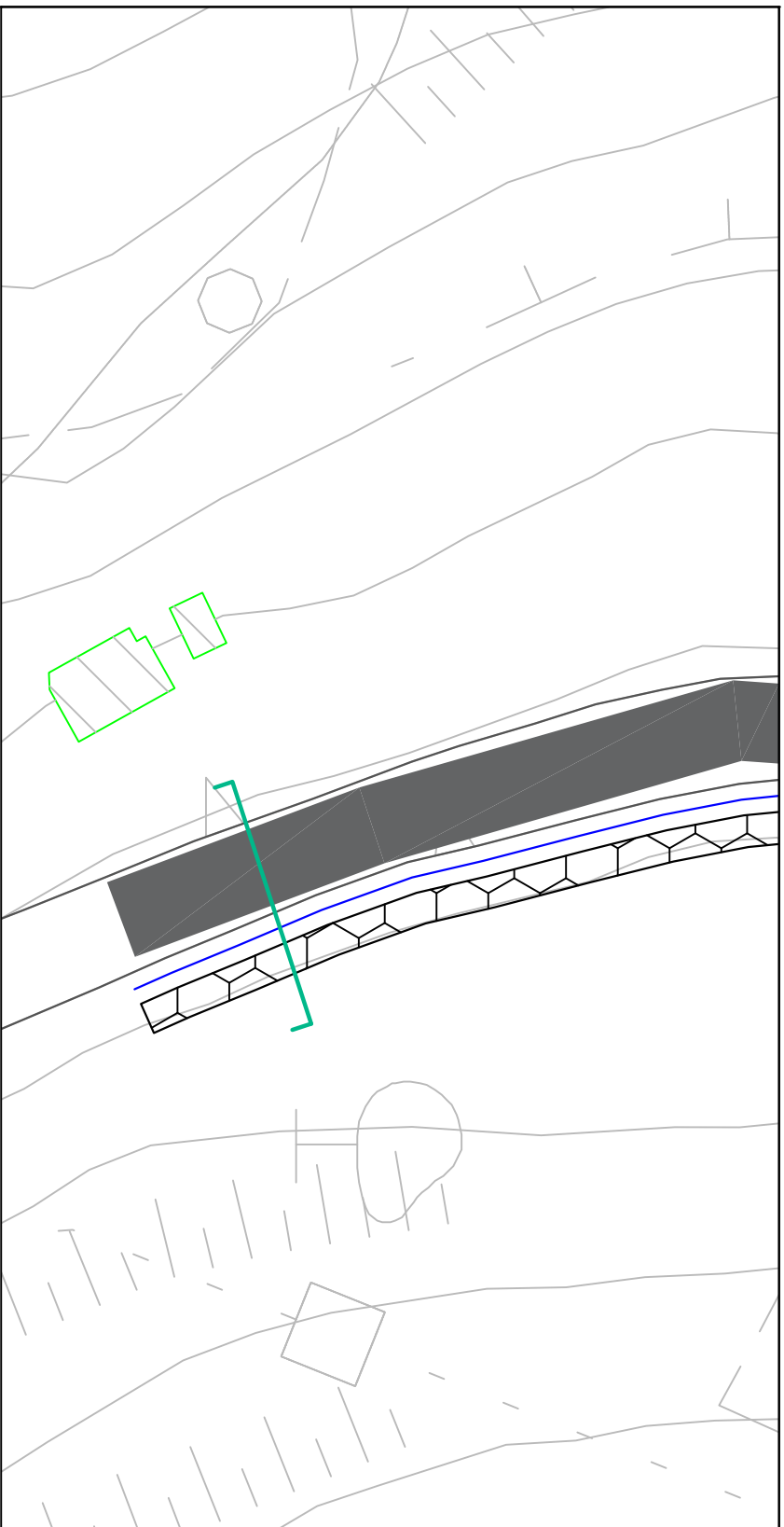

Gabbionata  
rinverdita

Talee

Zanella con  
rivestimento  
in pietra

Tappetino  
Binder  
Strato di fondazione

5%

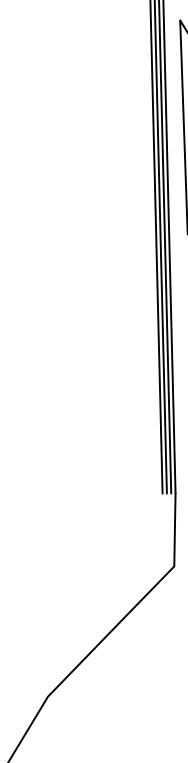

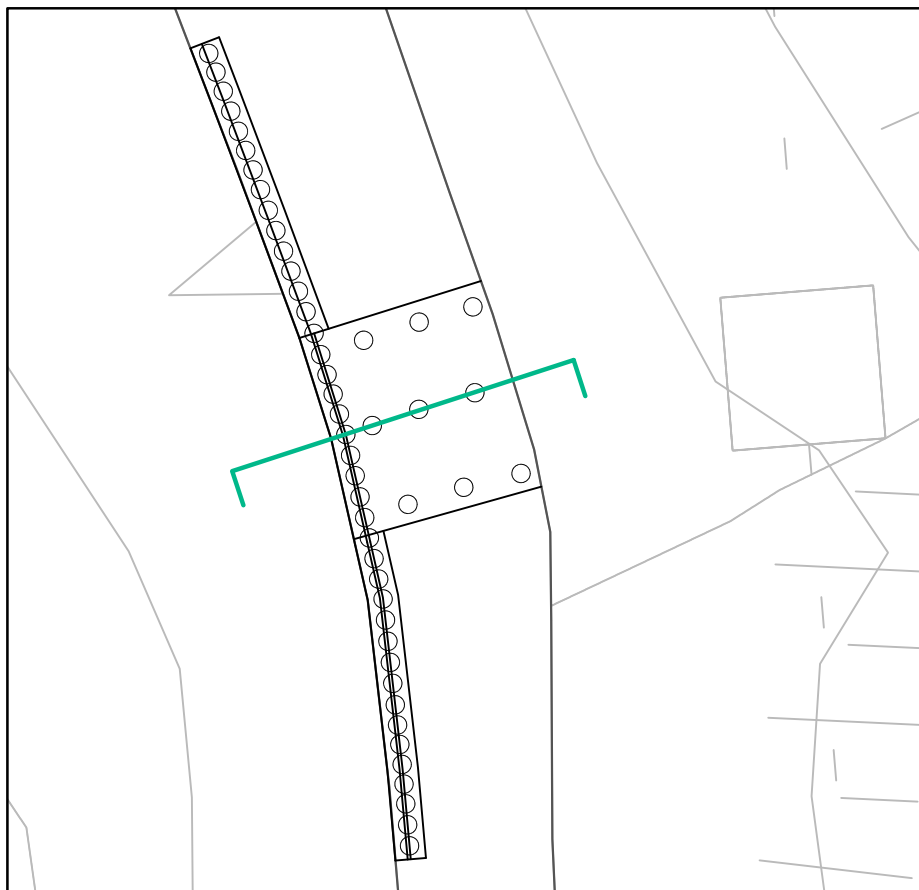

PARTICOLARE COSTRUTTIVO  
ATTRAVERSAMENTO

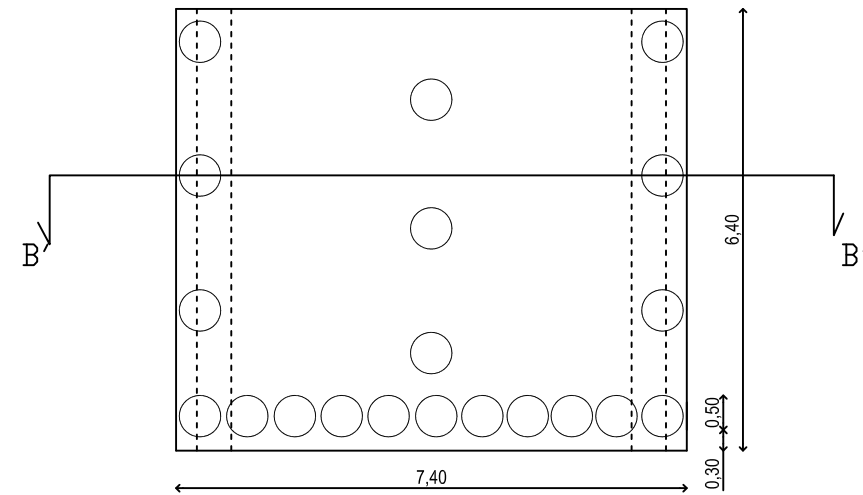

PIANTA PLATEA DI FONDAZIONE

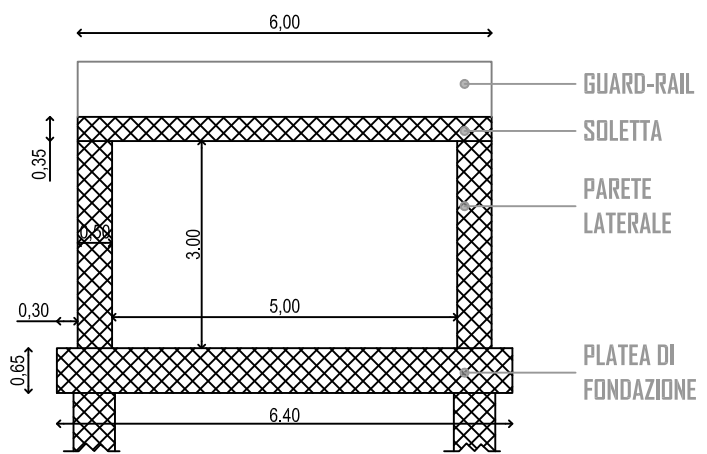
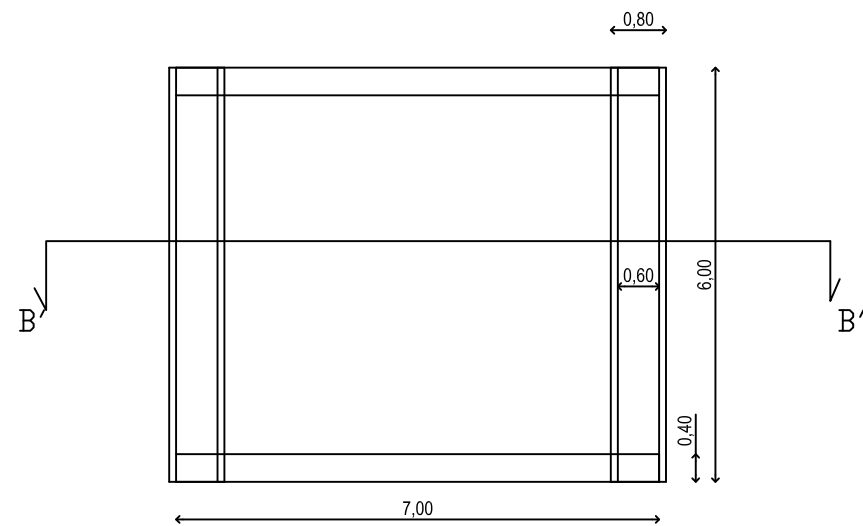

SEZIONE B'-B'

SEZIONE B-B - STATO DI FATTO

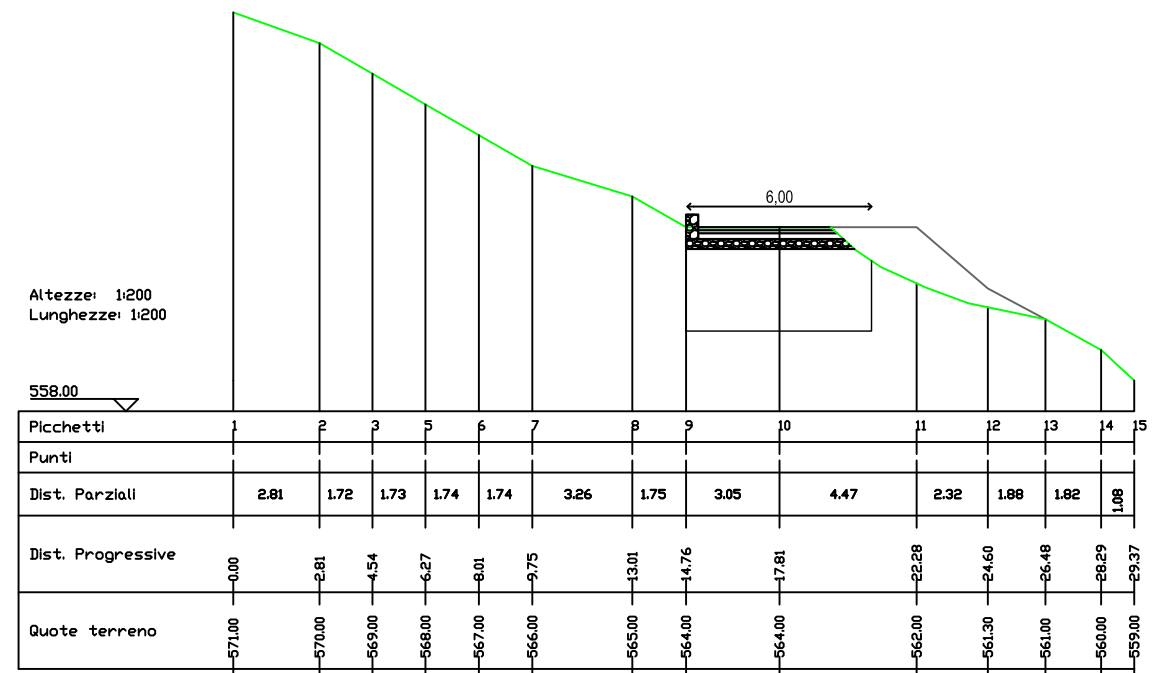

SEZIONE B-B - PROGETTO

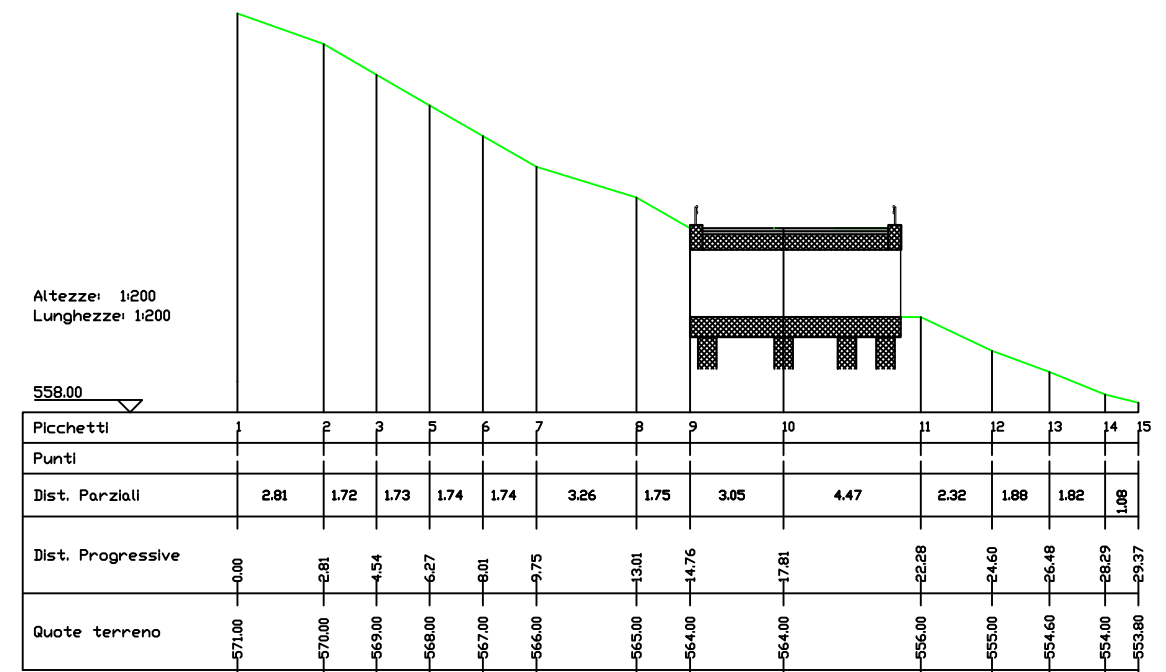

PROSPETTO

